



1.4 INQUIRY

A. Bidder's Inquiry:

Sheet C0.25 shows the area by the two tanks being a base rock surfacing. The quantities show 62,403.41 sq ft of 4" base rock. Is this section included in that quantity and is in fact a 4" thickness? Does this area receive any fabric? Also there is a drainage swale on the lower section of the area. Please confirm this a rocked swale per 13B/C05.1, and not 13AC05.1.

Response:

The square footage is correct, however depending the application, the depths of the base will vary. Location for the 4" base depth would be for sidewalks, walkways, standalone equipment pads, (per existing and added details on C05.1 and C05.2 - see next sheet), and landscape areas that has decomposed granite walkways (such as areas behind rear parking lot).

All driving surfaces (including tank pad area) shall use 6" thick base depth. Geotextile fabric shall be added to all driving surface separating compacted soil to compacted base.

The drainage swale shall be compacted base per detail 7 on sheet C05.2 - which is forthcoming on Addendum E.

Details on this RFI will be added to Addendum E Plan Set

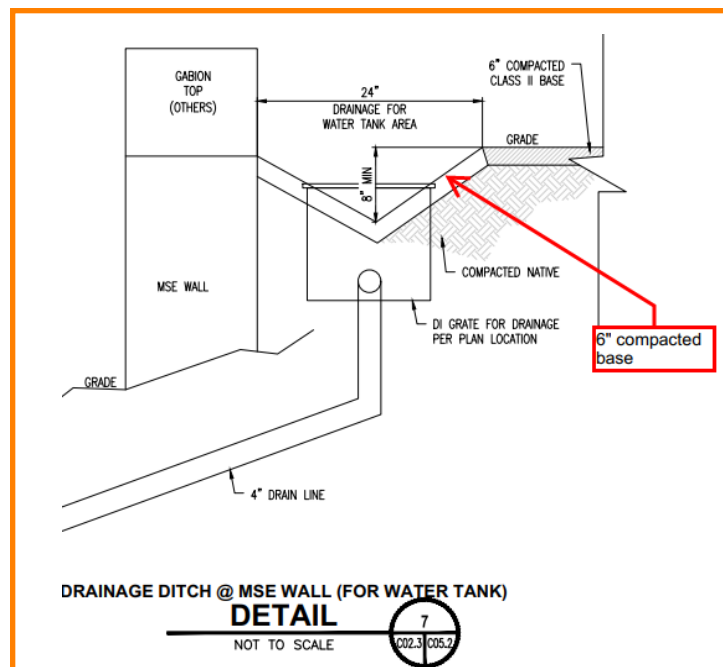

B. Signed: TVCE

C. Date: 24/4/26



PART 2 - PRODUCTS (Not Used)
PART 3 - EXECUTION (Not Used)

END OF DOCUMENT 006313.13

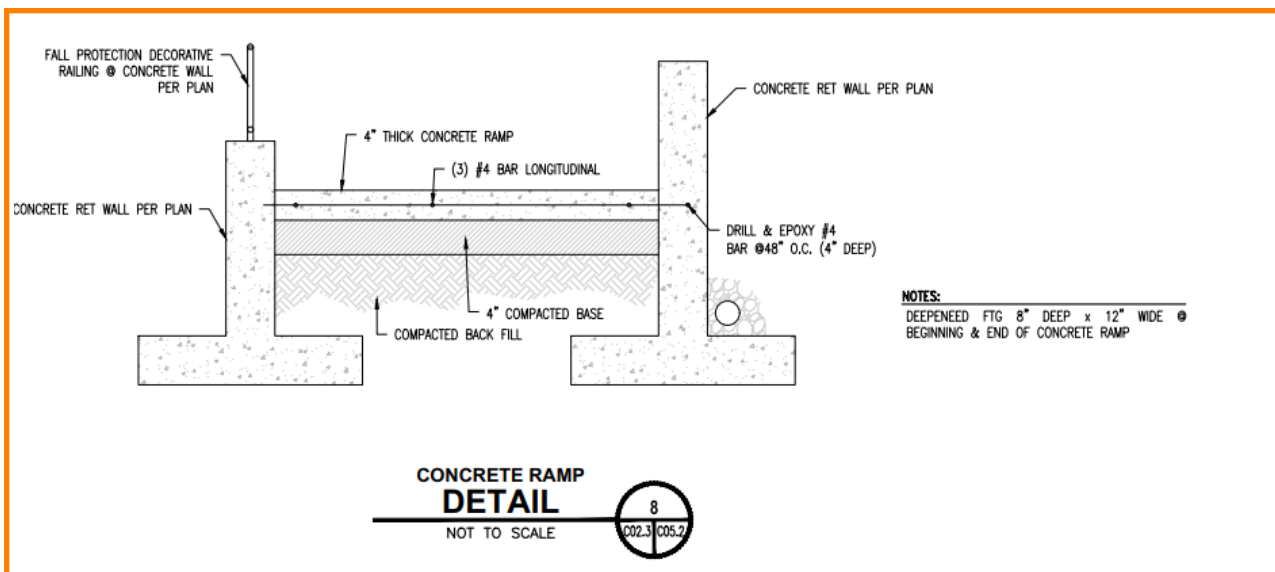
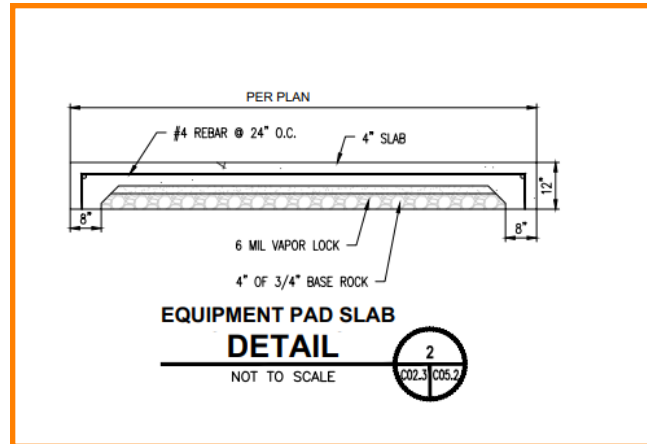



DOCUMENT 006313.13 - REQUEST FOR INTERPRETATION FORM (RFI), BIDDING PHASE

PART 1 - GENERAL

1.1 SUMMARY

- A. Bidders: Utilize this form to request information required for clarifications and interpretations of the Bidding Documents.
- B. Refer to Document 002113 "Instructions to Bidders" for instructions for submittal of this form and for definitions used on this form.
- C. Response to this request by the Architect will be in the form of a written Addendum issued to all Bidders. If response to request is not published, use specified product.

1.2 PROJECT INFORMATION

- A. Project Name: Yurok Regional Wellness Center.
- B. Project Location: Weitchpec, CA.
- C. Owner: Yurok Tribe.
- D. Architect: Pyatok.

1.3 BIDDING REQUEST INFORMATION

- A. Bidder: [WHITSON PLUMBING AND ELECTRICAL](#)
Email: whitson@clearcloud.net
- B. Specification Section No.: [33 30 00](#)
_____.
- C. Drawing Sheet/Detail Number: [C03.2 ; C05.3](#)
_____.



1.4 INQUIRY

A. Bidder's Inquiry:

1. Is there to be (1) Orenco control panel for both waste water systems or (2).

2. Where are the control panel(s) to be located on the plans. C03.2 shows a controller mounted on a retaining wall outside of the MCB area.

3. Will more specifications/ requirements/ wiring diagrams be provided for the waste water system?

4. Is Orenco providing the design for this system?

4. What panel board is providing power to Orenco controller(s)?

5. Are orifice shields or infiltrators to be used in leach fields? If infiltrators what size?

6. Will there be any Advantex treatment pods in this system?

Response: TVCE 4/20/26

1 - Each system will have a separate control panel for the effluent pumps.

2 - The control panels for the Commons-East Bldg will be located at the south face of the Commons building. Adjacent to the HVAC condensor units. This will be updated on Civil and has been coordinated with MEP plans.

The West House control panel will be located adjacent to the maintenance shed double entry doors and NOT on the retaining wall.

3 - No, the information provided should suffice for the installation.

4 - This has been coordinated with MEP plans. Addendum C will specify this.

5 - Infiltrator callouts have been updated and will be used for both fields.

Quick4, low profile infiltrators shall be used for Commons_East. Orifice Shields shall be used for West Bldg Septic field. This information will be updated in Addendum C Civil Plan Set.

6 - No Advantex Treatment Pods.

B. Signed: Nathaniel Vincent- Estimator

C. Date: 04/13/26

PART 2 - PRODUCTS (Not Used)
PART 3 - EXECUTION (Not Used)

END OF DOCUMENT 006313.13

BUILDERS DOOR & WINDOW, Inc.

3790 Old 44 Drive
Redding, CA 96003

P: 530-221-3667
F: 530-221-0131

To: Whitchurch Engineering, Inc.
Attn: Estimator

Date: 4/13/2026

From: Sean Carmody

Project: Yurok Regional Wellness Center

Location: 93 Rube Ranch Road
Weitchpec, CA

Request For Information #1 (Bidding Process):

- 1) Confirm hardware group 34 is not used. I don't see it on the door schedules anywhere.
- 2) Provide a hardware group for openings E108 & W111D.
- 3) I see that multiple door & frame types are not being used. Confirm
- 4) Confirm all interior sliding barn doors are wood & flush (no lite cutouts). Door schedule is missing this information.
- 5) Where is section 081216 (aluminum frames) used at? There are no details on the door schedules for these frames that I can see. These all have aluminum doors as well. Provide some clarification.
- 6) The Schlage MT15 card reader will need to be supplied & installed by an access controller or security contractor. I don't see a specification for access control. Provide some clarification. The MT15 is listed in the hardware groups.

5/1/26 Response - PYATOK Architects

1. Hardware Group 34 is not used and has been deleted from Hardware Schedule.
2. E108: Provide HW Group 27
There is no door opening W111D. That opening number is not used.
3. Confirmed that not all door and frames types indicated on schedules are used. Dis-regard doors and frame types that are specifically indicated in the door schedules
4. Door schedule updated to clarify which sliding barn doors have lites and which are flush.
5. Section 081216 applies to aluminum frames and doors scheduled as Interior Storefront on drawings. See Interior Storefront Schedules on AC9.30, AE9.30 & AW9.30 for added detail references.
6. Card reader will be supplied and installed by Security Contractor. See Revisions to Electrical Specifications included in Bid Addendum B for information regarding design build security system.



DOCUMENT 006313.13 - REQUEST FOR INTERPRETATION FORM (RFI), BIDDING PHASE

PART 1 - GENERAL

1.1 SUMMARY

- A. Bidders: Utilize this form to request information required for clarifications and interpretations of the Bidding Documents.
- B. Refer to Document 002113 "Instructions to Bidders" for instructions for submittal of this form and for definitions used on this form.
- C. Response to this request by the Architect will be in the form of a written Addendum issued to all Bidders. If response to request is not published, use specified product.

1.2 PROJECT INFORMATION

- A. Project Name: Yurok Regional Wellness Center.
- B. Project Location: Weitchpec, CA.
- C. Owner: Yurok Tribe.
- D. Architect: Pyatok.

1.3 BIDDING REQUEST INFORMATION

- A. Bidder: [WHITSON PLUMBING AND ELECTRICAL](#)
Email: whitson@clearcloud.net
- B. Specification Section No.: [33 71 00](#)
_____.
- C. Drawing Sheet/Detail Number: [E 1.01; E2](#)
_____.



1.4 INQUIRY

A. Bidder's Inquiry:

1. Will there be an applicant designer for Electric Utilities, or is PGE doing the design work?
2. Will there be approved utility drawings provided during the bidding process?
3. Are contractors bidding " at risk" if no approved utility drawings are to be made available?
4. If " design/ build" please indicate.

Response:

The electrical utility service to the site is currently being worked on by PG&E (not applicant-designed). Because the process/design is still ongoing, the new electrical service will not be part of this Bid process.
Please provide costs for the Transformer pad and conduit per Electrical plans.

B. Signed: [Nathaniel Vincent- Estimator](#)

C. Date: [04/13/26](#)

PART 2 - PRODUCTS (Not Used)
PART 3 - EXECUTION (Not Used)

END OF DOCUMENT 006313.13



DOCUMENT 006313.13 - REQUEST FOR INTERPRETATION FORM (RFI), BIDDING PHASE

PART 1 - GENERAL

1.1 SUMMARY

- A. Bidders: Utilize this form to request information required for clarifications and interpretations of the Bidding Documents.
- B. Refer to Document 002113 "Instructions to Bidders" for instructions for submittal of this form and for definitions used on this form.
- C. Response to this request by the Architect will be in the form of a written Addendum issued to all Bidders. If response to request is not published, use specified product.

1.2 PROJECT INFORMATION

- A. Project Name: Yurok Regional Wellness Center.
- B. Project Location: Weitchpec, CA.
- C. Owner: Yurok Tribe.
- D. Architect: Pyatok.

1.3 BIDDING REQUEST INFORMATION

- A. Bidder: [WHITSON PLUMBING AND ELECTRICAL](#)
Email: whitson@clearcloud.net
- B. Specification Section No.: [26 32 13.13 ; 26 36 23](#)
_____.
- C. Drawing Sheet/Detail Number: [E 1.01](#)
_____.



1.4 INQUIRY

A. Bidder's Inquiry:

1. Will Cummins Genset and ATS of comparable specs to the Rehiko KD700 and KCS be acceptable substitutions?

1. A Cummins Genset and ATS that meet the specifications listed in the generator schedule and ATS schedule seen on E100 are acceptable substitutions.

James Kobelenz, E.I.T.
4/22/2026

B. Signed: Nathaniel Vincent- Estimator

C. Date: 04/13/26

PART 2 - PRODUCTS (Not Used)
PART 3 - EXECUTION (Not Used)

END OF DOCUMENT 006313.13



DOCUMENT 006313.13 - REQUEST FOR INTERPRETATION FORM (RFI), BIDDING PHASE

PART 1 - GENERAL

1.1 SUMMARY

- A. Bidders: Utilize this form to request information required for clarifications and interpretations of the Bidding Documents.
- B. Refer to Document 002113 "Instructions to Bidders" for instructions for submittal of this form and for definitions used on this form.
- C. Response to this request by the Architect will be in the form of a written Addendum issued to all Bidders. If response to request is not published, use specified product.

1.2 PROJECT INFORMATION

- A. Project Name: Yurok Regional Wellness Center.
- B. Project Location: Weitchpec, CA.
- C. Owner: Yurok Tribe.
- D. Architect: Pyatok.

1.3 BIDDING REQUEST INFORMATION

- A. Bidder: Wahlund Construction, Inc.. Email: Kyle@wahlcon.com, bids@wahlcon.com
- B. Specification Section No.:
_____.
- C. Drawing Sheet/Detail Number:
_____.

PYA Response (5/1/26):

3. Fire Alarm system is design/build. See G0.01 for assumed applicable codes and facility parameters.
6. No. See Addendum B 00-91-13.2 Section 1.7.A
7. No. See Addendum B 00-91-13.2 Section 1.7.A
11. Extension was provided in Addendum D.

TVCE Response (5/1/26)

4. Sheet CO3.9 Shows the necessary conduits that will come from the road onto the site for future Fiber/Data connection. These are (2) 2" conduits in ground. The detail shows a joint trench, however it is unclear yet if PGE will allow a joint trench. This will be determined at PGE design stage.
8. The pump house will have electrical connectivity. There will be a single 100 AMP sub-panel is shown on Sheet CO6.5.
9. Both of the septic systems will have electrical connection stemming from each specific building. West House and Commons Bldg. This will power the control panel and provide electricity to the pump. Due to the distance from electrical disconnect to the pumps in the dosing chambers, trenching for electrical connection should be accounted for - especially for Commons Septic Chamber. These have been updated on Sheet CO3.2.

Frontier CE Response (5/6/26):

1. PG&E utility drawings will not be provided during the bidding process. As soon as PG&E completes their drawings, they will be distributed accordingly.
 - Size and number of conduits for primary service shall be determined by PG&E drawings.
 - PG&E Pull Box ID number shall be provided on PG&E drawings.
 - Size and number of conduits for secondary service shall be determined by PG&E drawings. According to PG&E's greenbook, (7) 5" empty conduits shall be provided for utility secondary for a 2500A service.
 - Primary protection will be provided by PG&E.
2. Specifications for EV Chargers shall not be provided. A note has been added to E2.0 which states to provide a Chargepoint CT4000 or approved equal EV charger.
5. Yes. Each building will require data.
10. The electrical utility service to the site is currently being worked on by PG&E (not applicant-designed). Because the process/design is still ongoing, the new electrical service will not be part of this Bid process.
Please provide costs for the Transformer pad and conduit per Electrical plans.



DOCUMENT 006313.13 - REQUEST FOR INTERPRETATION FORM (RFI), BIDDING PHASE

PART 1 - GENERAL

1.1 SUMMARY

- A. Bidders: Utilize this form to request information required for clarifications and interpretations of the Bidding Documents.
- B. Refer to Document 002113 "Instructions to Bidders" for instructions for submittal of this form and for definitions used on this form.
- C. Response to this request by the Architect will be in the form of a written Addendum issued to all Bidders. If response to request is not published, use specified product.

1.2 PROJECT INFORMATION

- A. Project Name: Yurok Regional Wellness Center.
- B. Project Location: Weitchpec, CA.
- C. Owner: Yurok Tribe.
- D. Architect: Pyatok.

1.3 BIDDING REQUEST INFORMATION

- A. Bidder: Wahlund Construction, Inc.. Email: Kyle@wahlcon.com, bids@wahlcon.com
- B. Specification Section No.: _____
- C. Drawing Sheet/Detail Number: _____

TVCE Response (5/1/26)

1. Sheet CO3.9 Shows the necessary conduits that will come from the road onto the site for future Fiber/Data connection. These are (2) 2" conduits in ground. The detail shows a joint trench, however it is unclear yet if PGE will allow a joint trench. This will be determined at PGE design stage.

Frontier CE Response (5/6/26):

2. IDF's will be necessary and have not been implemented in the electrical design as of this set. The west house and east house shall have (1) IDF each. Current proposed locations are in the electrical rooms for each building. Locations are subject to change.

3. IT equipment shall be provided and coordinated by Yurok Tribe's IT department. For bidding purposes, Frontier has provided specifications for Divisions 27 and 28 for contractors to use.

4. Specifications for Divisions 27 have now been provided. Contractors shall use these specifications as the basis for estimating their project bid regarding technology.

5. Specifications for Divisions 28 have now been provided. Contractors shall use these specifications as the basis for estimating their project bid regarding technology. Also see Addendum B 00-91-13.2 Section 1.7.A with regard to security design/ build specifications.

6. Data drawings shall not be provided.



DOCUMENT 006313.13 - REQUEST FOR INTERPRETATION FORM (RFI), BIDDING PHASE

PART 1 - GENERAL

1.1 SUMMARY

- A. Bidders: Utilize this form to request information required for clarifications and interpretations of the Bidding Documents.
- B. Refer to Document 002113 "Instructions to Bidders" for instructions for submittal of this form and for definitions used on this form.
- C. Response to this request by the Architect will be in the form of a written Addendum issued to all Bidders. If response to request is not published, use specified product.

1.2 PROJECT INFORMATION

- A. Project Name: Yurok Regional Wellness Center.
- B. Project Location: Weitchpec, CA.
- C. Owner: Yurok Tribe.
- D. Architect: Pyatok.

1.3 BIDDING REQUEST INFORMATION

- A. Bidder: Wahlund Construction, Inc.. Email: Kyle@wahlcon.com, bids@wahlcon.com
- B. Specification Section No.:
_____.
- C. Drawing Sheet/Detail Number:
_____.

Frontier CE Response (5/1/26):

1. a. Yes, generator specifications will be provided.

1. b. 1. A generator that meet the specifications listed in the generator specifications and generator schedule seen on E100 are acceptable substitutions. Please also see RFI response to "RFI #3 Generator".



1.4 INQUIRY

A. Bidder's Inquiry:

Sheet C03.2 Detail 2 has a 1000-gallon traffic rated grease tank. Will the attached 1200 Hilfiker vault be acceptable as a substitution?

Response

A Hilfiker concrete tank would be acceptable, **however not this one.**

The tank needs to have minimum two separate compartments, each side with individual access for adequate separation of solids and to prevent short-circuiting.

Proper layout of inlet/ outlet sanitary Tees will need to follow requirements from the CA Plumbing Code.

Lids must be sealed to prevent odor emission.

More details will be added to Addendum E plan set.

B. Signed: TVCE

C. Date: 24/04/26



Yurok Regional Wellness
Center
Weitchpec, California

PART 2 - PRODUCTS (Not Used)
PART 3 - EXECUTION (Not Used)

END OF DOCUMENT 006313.13



1.4 INQUIRY

A. Bidder's Inquiry:

C03.3 shows a foundation drain going around several of the buildings. Is there a detail for this drainage along the building foundation?

Response

Referenced Structural detail on Structural Dwgs sheet S503, and Architectural Dwg sheet A8.02

B. Signed: TVCE

C. Date: 24/04/26



Yurok Regional Wellness
Center
Weitchpec, California

PART 2 - PRODUCTS (Not Used)
PART 3 - EXECUTION (Not Used)

END OF DOCUMENT 006313.13



DOCUMENT 006313.13 - REQUEST FOR INTERPRETATION FORM (RFI), BIDDING PHASE

PART 1 - GENERAL

1.1 SUMMARY

- A. Bidders: Utilize this form to request information required for clarifications and interpretations of the Bidding Documents.
- B. Refer to Document 002113 "Instructions to Bidders" for instructions for submittal of this form and for definitions used on this form.
- C. Response to this request by the Architect will be in the form of a written Addendum issued to all Bidders. If response to request is not published, use specified product.

1.2 PROJECT INFORMATION

- A. Project Name: Yurok Regional Wellness Center.
- B. Project Location: Weitchpec, CA.
- C. Owner: Yurok Tribe.
- D. Architect: Pyatok.

1.3 BIDDING REQUEST INFORMATION

- A. Bidder: Mercer Fraser .
Email: ahunt@mercerfraser.com .
- B. Specification Section No.:
_____.
- C. Drawing Sheet/Detail Number: C03.3, Detail 1/C03.6 & Detail
4/C05.1 _____.



1.4 INQUIRY

A. Bidder's Inquiry:

Sheet C03.3 shows various French drains behind walls and some that aren't behind any retaining wall features. Details 1/C03.6 and 4/C05.1 show what they look like behind the walls. Are there any other details or dimensions of how the French drain is elsewhere onsite? Also where the French drain daylight on the west side of the site, is this a dirt swale the water runs into?

Response:

The attached detail will be added to Addendum E plan set and should be used for areas that are not behind retaining structures.

Regarding beyond the day-lighting french drain: this will discharge into a rock lined ditch. Attached detail will also be added to Addendum E.

Lastly, do note the other non retaining drainage lines for updates and details.

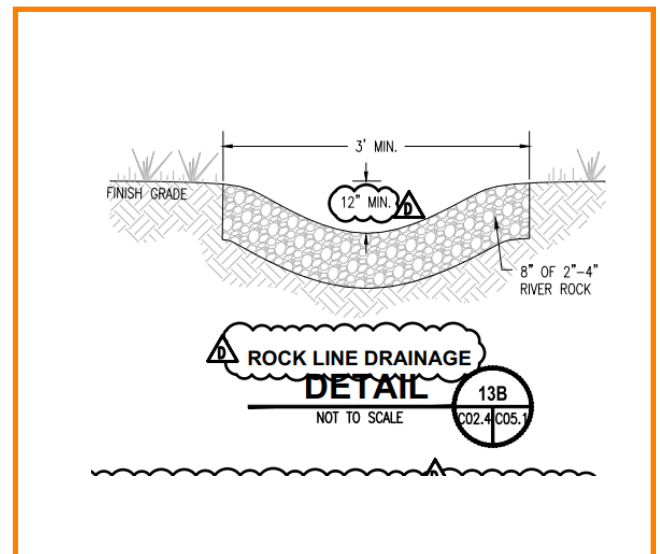
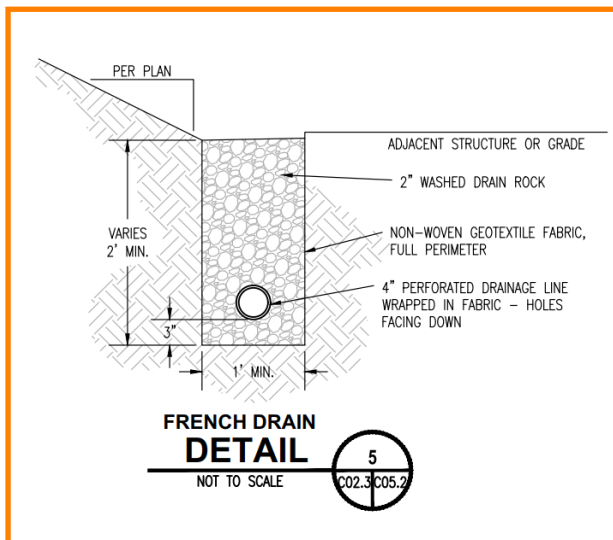

B. Signed: TVCE

C. Date: 24/04/26



Yurok Regional Wellness
Center
Weitchpec, California

PART 2 - PRODUCTS (Not Used)
PART 3 - EXECUTION (Not Used)

END OF DOCUMENT 006313.13



1.4 INQUIRY

A. Bidder's Inquiry:

Please confirm that the highlighted areas on the attached C03.3 are the extent of fabric, perforated pipe and drain rock for the French drain system.

Response

Please see attached dwg with confirmed area and added french drainage areas. These updates will be reflected in Addendum E plans.

B. Signed: TVCE _____

C. Date: 24/04/26 _____



Yurok Regional Wellness
Center
Weitchpec, California

PART 2 - PRODUCTS (Not Used)
PART 3 - EXECUTION (Not Used)

END OF DOCUMENT 006313.13

SITE STORM DRAIN DRAINAGE SHEET

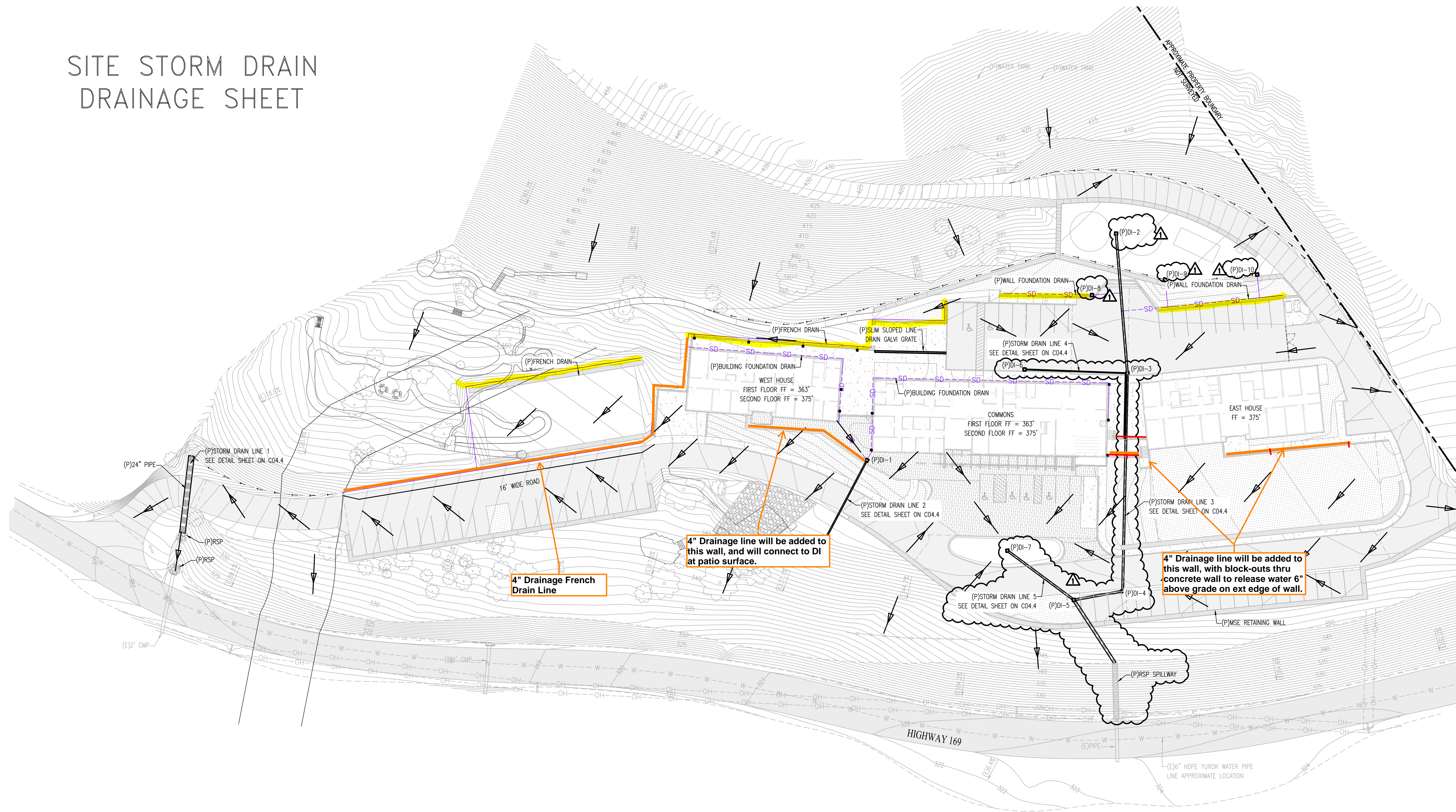

STAMP:

ISSUE SCHEDULE		
PLAN CHECK		02/21/2025
BID SET		03/27/2026

REVISION SCHEDULE		
NO.	ISSUE	DATE
1	BID ADDENDUM B	04/10/2026

JOB NUMBER:	1603
DRAWN BY:	RM
CHECKED BY:	RM
ISSUE DATE:	06/09/2025
SCALE:	AS SHOWN
TITLE:	SITE STORM DRAIN DRAINAGE SHEET

SHEET:
C03.3



DOCUMENT 006313.13 - REQUEST FOR INTERPRETATION FORM (RFI), BIDDING PHASE

PART 1 - GENERAL

1.1 SUMMARY

- A. Bidders: Utilize this form to request information required for clarifications and interpretations of the Bidding Documents.
- B. Refer to Document 002113 "Instructions to Bidders" for instructions for submittal of this form and for definitions used on this form.
- C. Response to this request by the Architect will be in the form of a written Addendum issued to all Bidders. If response to request is not published, use specified product.

1.2 PROJECT INFORMATION

- A. Project Name: Yurok Regional Wellness Center.
- B. Project Location: Weitchpec, CA.
- C. Owner: Yurok Tribe.
- D. Architect: Pyatok.

1.3 BIDDING REQUEST INFORMATION

- A. Bidder: Mercer Fraser .
Email: ahunt@mercerfraser.com .
- B. Specification Section No.:
_____.
- C. Drawing Sheet/Detail Number:



1.4 INQUIRY

A. Bidder's Inquiry:

Where is the closest allowable water source for the project for dust control, moisture conditioning of grading materials and testing of waterlines?

Response:

Per Yurok Tribe Planning Department, there is water access for construction purposes at the Tulley Creek Emergency Complex on Tulley Creek Rd. Approximately 2 miles from the site. Water rates apply. Specific cost of water not confirmed but relatively low: Approx. \$5 per 750 gallons.

B. Signed: TVCE

C. Date: 4/24/26



Yurok Regional Wellness
Center
Weitchpec, California

PART 2 - PRODUCTS (Not Used)
PART 3 - EXECUTION (Not Used)

END OF DOCUMENT 006313.13